

**SACC-DSIV-MS-8CON-L180 SCO THR**

Order No.: 1551765

<http://eshop.phoenixcontact.de/phoenix/treeViewClick.do?UID=1551765>

Sensor/actuator flush-type connector, connector, 8-pos., M12  
SPEEDCON, A-coded, rear/screw mounting with M12 thread, with  
straight THR solder connection

**Product notes**

WEEE/RoHS-compliant since:  
04/13/2007

**Commercial data**

GTIN (EAN)	 4 046356 162067
sales group	D125
Pack	60 pcs.
Customs tariff	85366990
Catalog page information	Page 32 (PC-2009)

[http://  
www.download.phoenixcontact.com](http://www.download.phoenixcontact.com)  
Please note that the data given  
here has been taken from the  
online catalog. For comprehensive  
information and data, please refer  
to the user documentation. The  
General Terms and Conditions of  
Use apply to Internet downloads.

**Technical data****General data**

Rated current at 40°C	2 A
Rated voltage	30 V
Number of positions	8
Volume resistance	≤ 3 mΩ

Insulation resistance	≥ 100 MΩ
<b>General characteristics</b>	
Coding	A - standard
Surge voltage category	II
Pollution degree	3
Degree of protection	IP67
Contact material	CuZn
Contact surface material	Au
Contact carrier material	PA 66
Material, knurls	Zinc die-cast, (nickel-plated)
Sealing material	FKM / EPDM
Mounting type	Rear mounting M12 x 1 With flat nut
Type of connection	THR solder connection
Status display	No

**Diagrams/Drawings**

Drilling plan/solder pad geometry

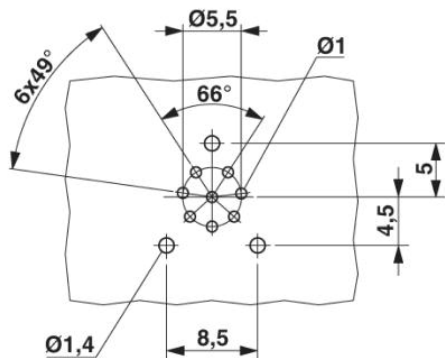

Dimensioned drawing

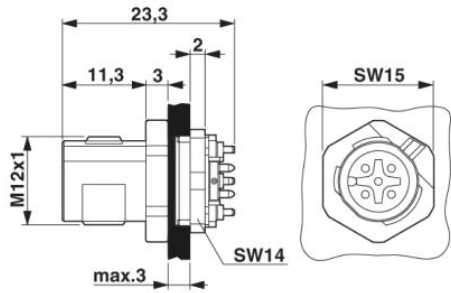

M12 flush-type connector

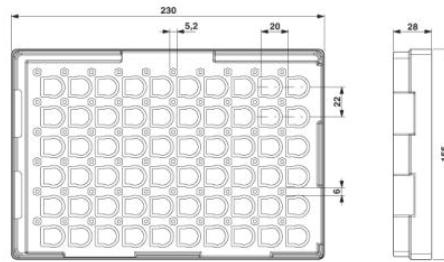

THR tray packaging

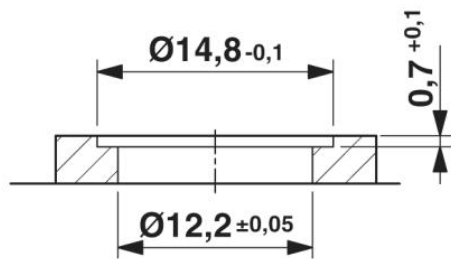

Housing cut-out for two-part M12 flush-type connectors with THR and wave soldering connection, version 1

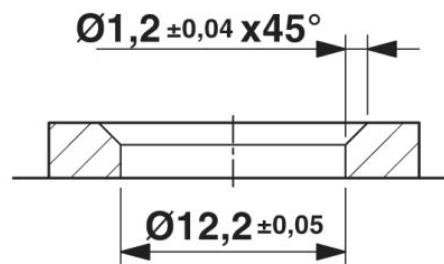

Housing cut-out for two-part M12 flush-type connectors with THR and wave soldering connection, version 2

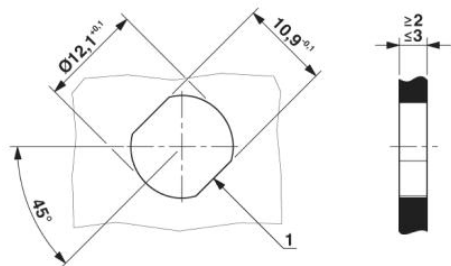

Housing cutout for M12 fastening thread, mounting panel with feed-through hole (alternative with surface as protection against rotation)

Schematic diagram

Pin assignment M12 plug, 8-pos., view plug side

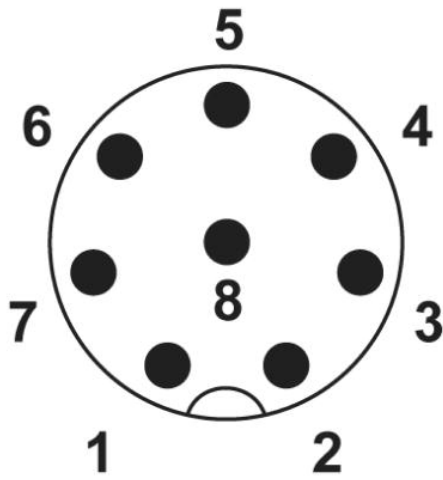

**Address**

PHOENIX CONTACT Inc., USA  
586 Fulling Mill Road  
Middletown, PA 17057, USA  
Phone (800) 888-7388  
Fax (717) 944-1625  
<http://www.phoenixcon.com>



© 2010 Phoenix Contact  
Technical modifications reserved;